



# Munters EMS 50-36-30

## Air circulation fans

The EMS Series is one of the first air circulators families designed and produced by Munters, widely used in poultry (broiler, layer) and dairy ventilation systems.

### Features

- Superior durability with Munters Protect coating, 3 years warranty against corrosion
- Easy installation and maintenance
- High airflow capacity
- Reduced energy consumption
- EMS 50 features high efficiency motor, in according to EU regulation

Munters EMS 50-36-30 are the ideal air circulators whenever extra high airflow capacity is required, thanks to their unique propeller design that guarantees full efficiency and reliability.

Munters EMS Series features the housing, conveyor and 6-blade propeller made in Munters Protect coated steel for extra strength and resistance against corrosion. Central hub and v-belt pulley are made of die-cast aluminum for long-lasting use.

The belt drive system enables low speed propeller, which results in reduced energy consumption and noise level, assuring a comfortable environment for both animals and operators.

Munters EMS air circulators feature some special threaded bushes on their side panels that allow the farmer to easily hang the fans on the wall and a welded wire mesh divided into two sections to ensure easy maintenance.

As market leader in ventilation solutions for more than 60 years, Munters guarantees quality and is ISO 9001 certified.

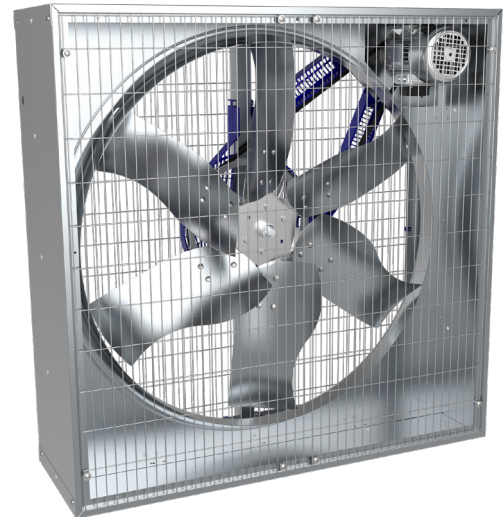

EMS36 front view

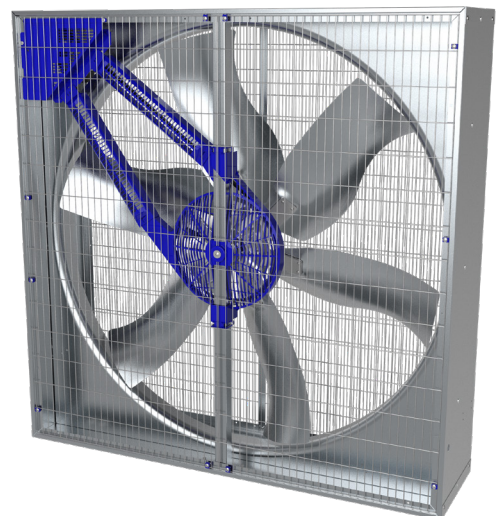

EMS50 rear view

# Munters EMS 50-36-30

## Air circulation fans

### Dimensions

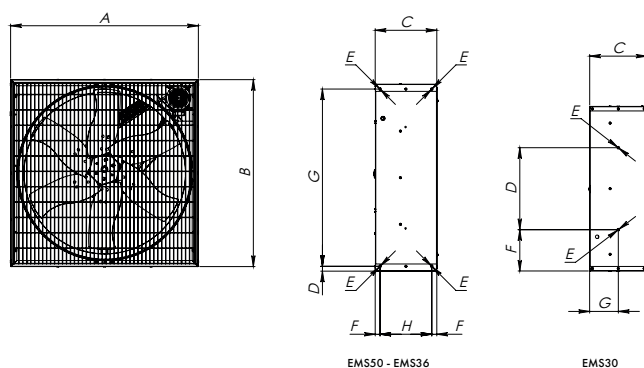

	A	B	C	D	E	F	G	H
EMS50	1380 mm	1380 mm	353 mm	28 mm	M8	27 mm	1315 mm	300 mm
EMS36	1090 mm	1090 mm	358 mm	28 mm	M8	29 mm	1027 mm	300 mm
EMS30	950 mm	950 mm	331 mm	475 mm	M8	239 mm	166 mm	-

### Technical specifications

		EMS50		EMS36		EMS30		
Nominal power	Hp	1.0	1.5	0.5	0.75	1.0	0.5	0.75
Propeller diameter	mm [inch]	1270 [50]		915 [36]		770 [30]		
Number of blades/material		6/Munters Protect		6/Munters Protect		6/Munters Protect		
Transmission		Belt drive		Belt drive		Belt drive		
Weight of fully equipped fan	kg	66	68	53	54	56	39	41
Max power consumption/max current <sup>1</sup>	W/A	1150/2.1	1830/3.3	570/1.1	870/1.6	1150/2.1	570/1.1	870/1.6
Max operating temperature	°C [°F]	50 [122]		50 [122]		50 [122]		
Motor insulation grade/protective class		F/IP55		F/IP55		F/IP55		
Noise level <sup>2</sup>	Db(a)	67.3	70.2	61.7	63.6	68.2	63.1	66.7

<sup>1</sup>50 Hz 400 V specification, 60 Hz available upon request, <sup>2</sup>Noise measure made according to ISO 3744

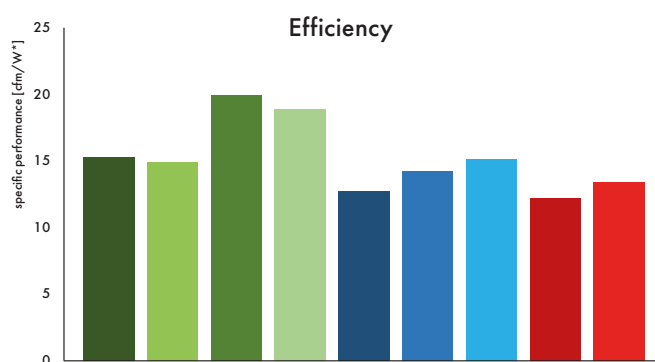
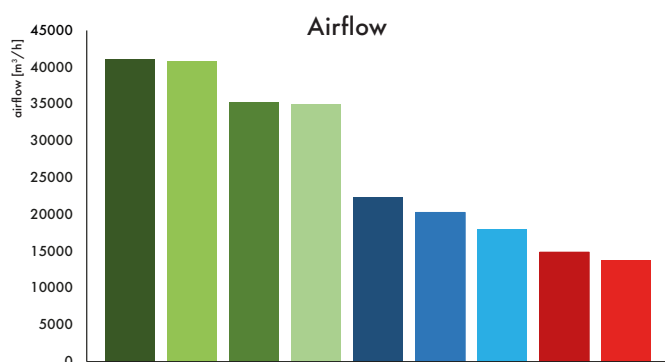

EMS50				EMS36			EMS30	
IE3		IE1		IE1		IE1		
■ Hp 1.5	■ Hp 1.0	■ Hp 1.5	■ Hp 1.0	■ Hp 1.0	■ Hp 0.75	■ Hp 0.5	■ Hp 0.75	■ Hp 0.5

Airflow and efficiency data measured at standard conditions (20°; 1013 hPa). \*1 cfm/W = 1.7 m³/hW

### Load capacity

	EMS50		EMS36	EMS30
	Unassembled	Assembled	Assembled	Assembled
20' Container	105	28	50	72
40' Container	-	57	104	144
40' HC Container	310	65	124	144
Truck	335	74	144	168

Find your nearest Munters office at [www.munters.com](http://www.munters.com)

Munters reserves the right to make alterations to specifications, quantities, etc., for production or other reasons, subsequent to publication. © Munters AB, 2021